

**Resilient seated swing check valve**  
**Face to face dimension to DIN 3202-F6 / BS 5153: 1974 (1991) short**  
**Flanges and drilling to ISO 7005-2 (EN 1092-2: 1997, DIN 2501)**

## Use:

For potable water and sewage to max. 70°C

## Tests:

Hydraulic test to BS 5153: 1974 (1991)

Seat: 1.1 x PN

Body: 1.5 x PN

## Optional extras:

Lever and spring kit

Lever and weight:

Mounted RHS as standard - can be mounted LHS on request

Guard (41/50)

Priming device (Series 41/64)

Metal seated disc (Series 41/70)

## Materials:

Body, bonnet and hinge Ductile iron, GGG-50, to DIN 1693 (BS 2789 grade 500-7)

Coating Electrostatically applied epoxy resin to DIN 30677 - Internally and externally

Shaft Stainless steel to W. no. 1.40S7 (BS 431S29)

Bonnet gasket EPDM rubber

Bushing Brass, CZ 132 to BS 2874

Hexagon bolt, washer and pin Stainless steel A2

Resilient seated disc EPDM rubber with a steel insert to EN 10113:1990 (BS 4360:1990)

## Accessory kit:

Weight, hinge lever and weight Ductile iron, GGG-50, to DIN 1693 (BS 2789 grade 500-7)

Spring, washer, hexagon bolt and pin Stainless steel A2

Guard

FE 360 B to W. no. 1.0037

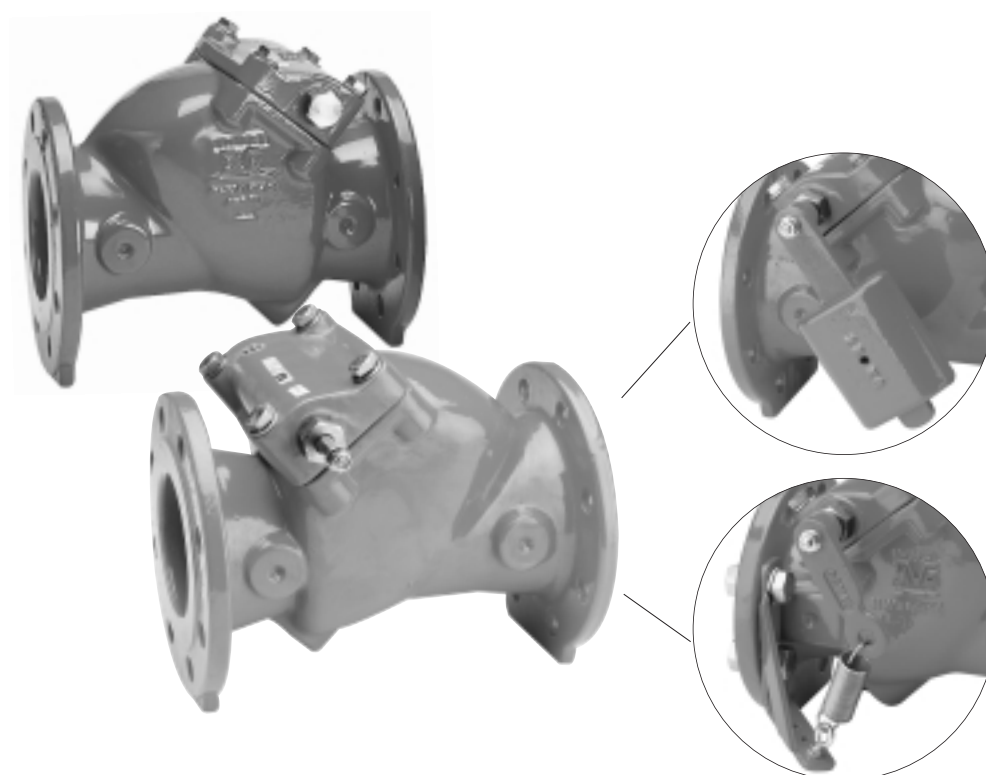

Resilient seated swing check valve with free shaft end or closed bushings  
Face to face dimension to DIN 3202-F6 / BS 5153: 1974 (1991) short  
Flanges and drilling to ISO 7005-2 (EN 1092-2: 1997, DIN 2501)

## Component list

- |                 |                  |             |
|-----------------|------------------|-------------|
| 1. Washer       | 6. Hexagon bolt  | 11. O-ring  |
| 2. Nylon spacer | 7. Hinge         | 12. O-ring  |
| 3. Bolt         | 8. Bonnet        | 13. Bushing |
| 4. Disc         | 9. Bonnet gasket | 14. Pin     |
| 5. Washer       | 10. Body         | 15. Shaft   |

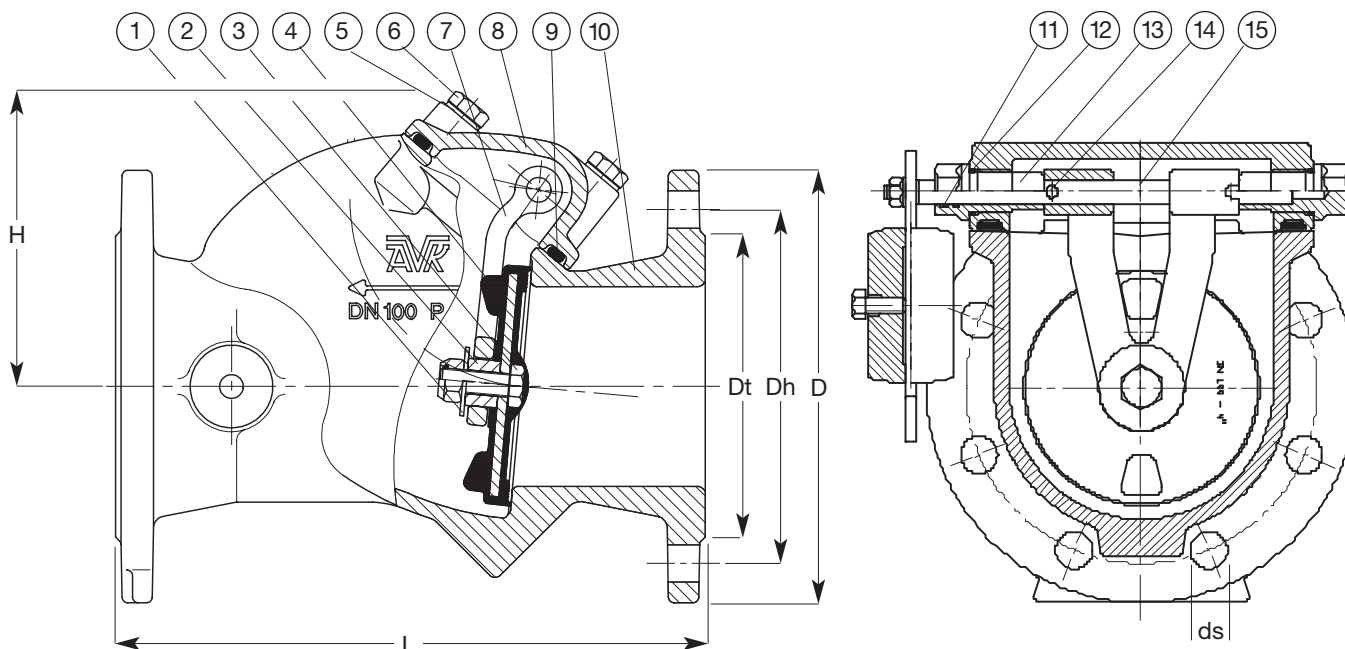

## With closed bushings

| Ref.nos.<br>DIN | Ref.nos.<br>BS | DN  | L (DIN)<br>mm | L (BS)<br>mm | H<br>mm | Dt<br>mm | D<br>mm | Dh<br>mm | ds<br>mm | Holes | Weight kilos<br>(theoretical) |
|-----------------|----------------|-----|---------------|--------------|---------|----------|---------|----------|----------|-------|-------------------------------|
| 41-050-61018    | 41-050-21018   | 50  | 200           | 203          | 110     | 102      | 165     | 125      | 19       | 4     | 13                            |
| 41-065-61018    | 41-065-21018   | 65  | 240           | 216          | 140     | 122      | 185     | 145      | 19       | 4     | 17                            |
| 41-080-61018    | 41-080-21018   | 80  | 260           | 241          | 140     | 138      | 200     | 160      | 19       | 8     | 20                            |
| 41-100-61018    | 41-100-21018   | 100 | 300           | 292          | 150     | 158      | 220     | 180      | 19       | 8     | 26                            |
| 41-125-61018    | 41-125-21018   | 125 | 350           | 330          | 195     | 188      | 254     | 210      | 19       | 8     | 40                            |
| 41-150-61018    | 41-150-21018   | 150 | 400           | 356          | 195     | 212      | 285     | 240      | 23       | 8     | 51                            |
| 41-200-61008    | 41-200-21008   | 200 | 500           | 495          | 230     | 268      | 340     | 295      | 23       | 8     | 83                            |
| 41-200-61018    | 41-200-21018   | 200 | 500           | 495          | 230     | 268      | 340     | 295      | 23       | 12    | 83                            |
| 41-250-61008    | 41-250-21008   | 250 | 600           | 622          | 270     | 320      | 406     | 350      | 23       | 12    | 183                           |
| 41-250-61018    | 41-250-21018   | 250 | 600           | 622          | 270     | 320      | 406     | 355      | 28       | 12    | 183                           |
| 41-300-61008    | 41-300-21008   | 300 | 700           | 699          | 300     | 370      | 482     | 400      | 23       | 12    | 231                           |
| 41-300-61018    | 41-300-21018   | 300 | 700           | 699          | 300     | 370      | 482     | 410      | 28       | 12    | 231                           |

0 = PN 10

1 = PN 16

## With free shaft end

| Ref.nos.<br>DIN | Ref.nos.<br>BS | DN  | L (DIN)<br>mm | L (BS)<br>mm | H<br>mm | Dt<br>mm | D<br>mm | Dh<br>mm | ds<br>mm | Holes | Weight kilos<br>(theoretical) |
|-----------------|----------------|-----|---------------|--------------|---------|----------|---------|----------|----------|-------|-------------------------------|
| 41-050-60018    | 41-050-20018   | 50  | 200           | 203          | 110     | 102      | 165     | 125      | 19       | 4     | 13                            |
| 41-065-60018    | 41-065-20018   | 65  | 240           | 216          | 140     | 122      | 185     | 145      | 19       | 4     | 17                            |
| 41-080-60018    | 41-080-20018   | 80  | 260           | 241          | 140     | 138      | 200     | 160      | 19       | 8     | 20                            |
| 41-100-60018    | 41-100-20018   | 100 | 300           | 292          | 150     | 158      | 220     | 180      | 19       | 8     | 26                            |
| 41-125-60018    | 41-125-20018   | 125 | 350           | 330          | 195     | 188      | 254     | 210      | 19       | 8     | 40                            |
| 41-150-60018    | 41-150-20018   | 150 | 400           | 356          | 195     | 212      | 285     | 240      | 23       | 8     | 51                            |
| 41-200-60008    | 41-200-20008   | 200 | 500           | 495          | 230     | 268      | 340     | 295      | 23       | 8     | 83                            |
| 41-200-60018    | 41-200-20018   | 200 | 500           | 495          | 230     | 268      | 340     | 295      | 23       | 12    | 83                            |
| 41-250-60008    | 41-250-20008   | 250 | 600           | 622          | 270     | 320      | 406     | 350      | 23       | 12    | 183                           |
| 41-250-60018    | 41-250-20018   | 250 | 600           | 622          | 270     | 320      | 406     | 355      | 28       | 12    | 183                           |
| 41-300-60008    | 41-300-20008   | 300 | 700           | 699          | 300     | 370      | 482     | 400      | 23       | 12    | 231                           |
| 41-300-60018    | 41-300-20018   | 300 | 700           | 699          | 300     | 370      | 482     | 410      | 28       | 12    | 231                           |

0 = PN 10

1 = PN 16

**Resilient seated swing check valve with solid rubber disc and integrated hinge.**  
**Face to face dimension to DIN 3202-F6 / BS 5153: 1974 (1991) short**  
**Flanges and drilling to ISO 7005-2 (EN 1092-2: 1997, DIN 2501)**

## Component list

- |                  |                  |
|------------------|------------------|
| 1. Washer        | 6. Bonnet gasket |
| 2. Hexagon screw | 7. Body          |
| 3. Disc insert   | 8. Bushing       |
| 4. Disc          | 9. O-ring        |
| 5. Bonnet        | 10. Shaft        |

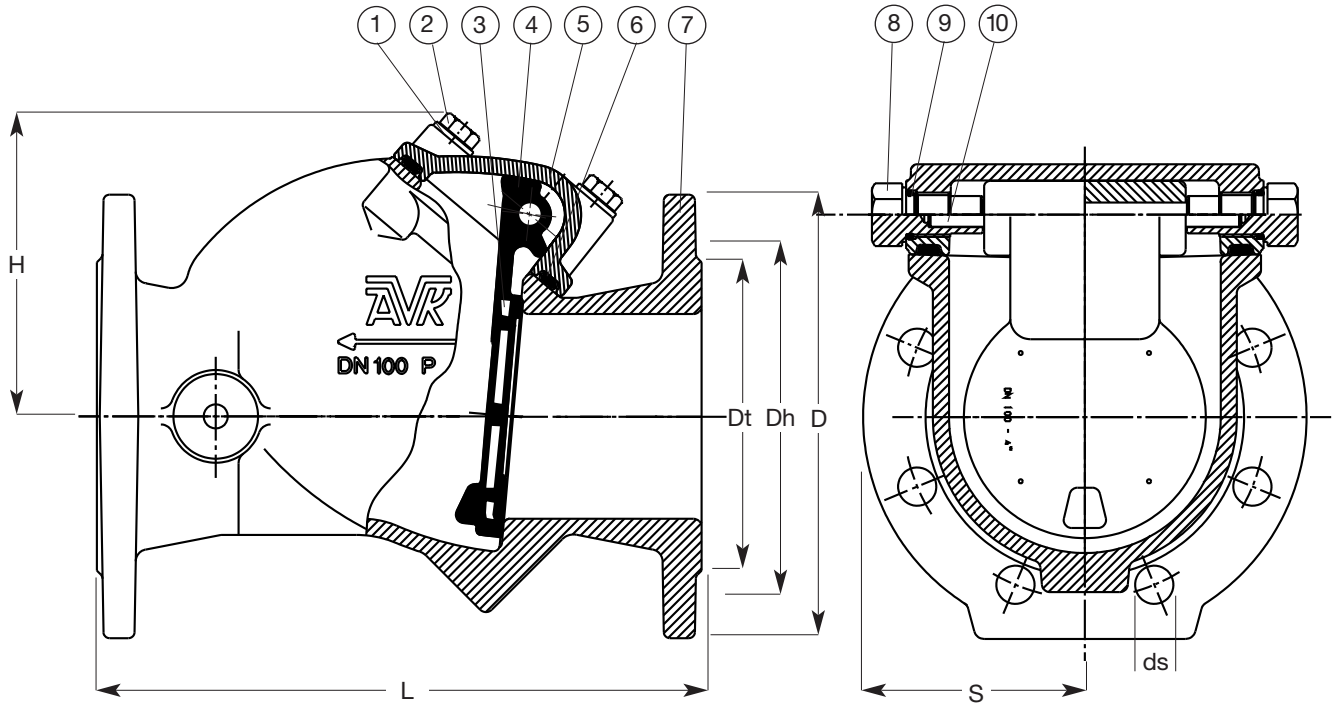

## With solid rubber disc and integrated hinge

| Ref.nos.<br>DIN | Ref.nos.<br>BS | DN  | L (DIN)<br>mm | L (BS)<br>mm | H<br>mm | Dt<br>mm | D<br>mm | Dh<br>mm | ds<br>mm | Holes | S<br>mm | Weight kilos<br>(theoretical) |
|-----------------|----------------|-----|---------------|--------------|---------|----------|---------|----------|----------|-------|---------|-------------------------------|
| 41-050-69018    | 41-050-29018   | 50  | 200           | 203          | 110     | 102      | 165     | 125      | 19       | 4     | 160     | 10                            |
| 41-065-69018    | -              | 65  | 240           | -            | 140     | 122      | 185     | 145      | 19       | 4     | 160     | 12                            |
| 41-080-69018    | 41-080-29018   | 80  | 260           | 246          | 140     | 138      | 200     | 160      | 19       | 8     | 160     | 15                            |
| 41-100-69018    | 41-100-29018   | 100 | 300           | 292          | 150     | 158      | 220     | 180      | 19       | 8     | 175     | 20                            |
| 41-125-69018    | -              | 125 | 350           | -            | 195     | 188      | 254     | 210      | 19       | 8     | 220     | 37                            |
| 41-150-69018    | 41-150-29018   | 150 | 400           | 356          | 195     | 212      | 285     | 240      | 23       | 8     | 220     | 40                            |
| 41-200-69008    | 41-200-29008   | 200 | 500           | 495          | 230     | 268      | 340     | 295      | 23       | 8     | 240     | 70                            |
| 41-200-69018    | 41-200-29018   | 200 | 500           | 495          | 230     | 268      | 340     | 295      | 23       | 12    | 240     | 70                            |

0 = PN 10  
1 = PN 16

**Resilient seated swing check valve**  
**Face to face dimension to DIN 3202-F6 / BS 5153: 1974 (1991) short**  
**Flanges and drilling to ISO 7005-2 (EN 1092-2: 1997, DIN 2501)**

## Component list

- |           |                |            |
|-----------|----------------|------------|
| 1. Lever  | 4. Spring      | 7. Washer  |
| 2. Weight | 5. Eyebolt     | 8. Bracket |
| 3. Lever  | 6. Hexagon nut |            |

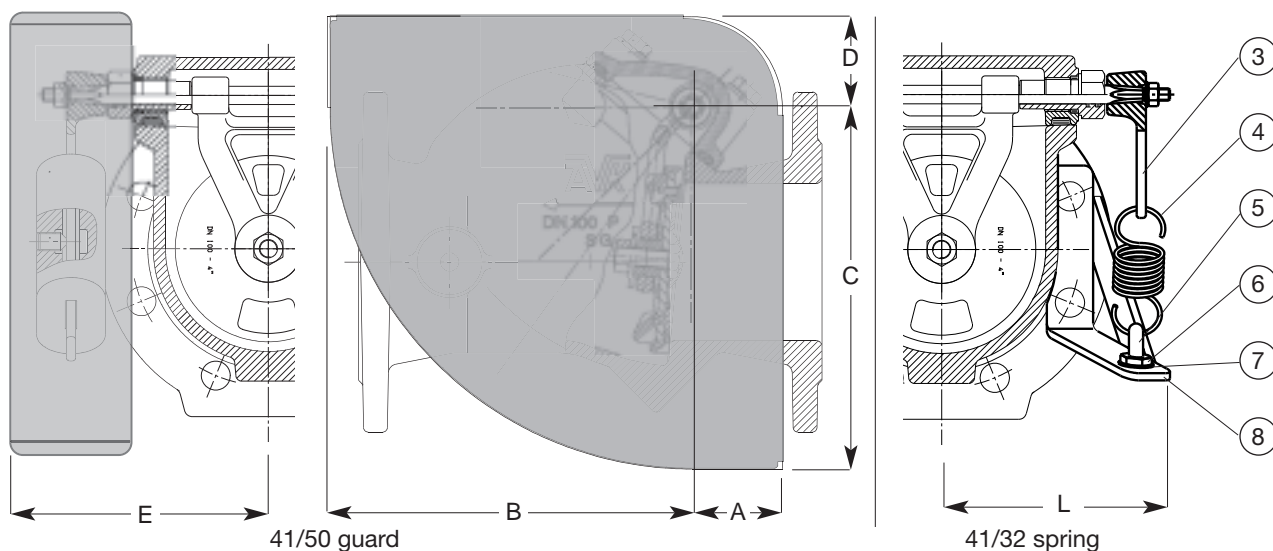
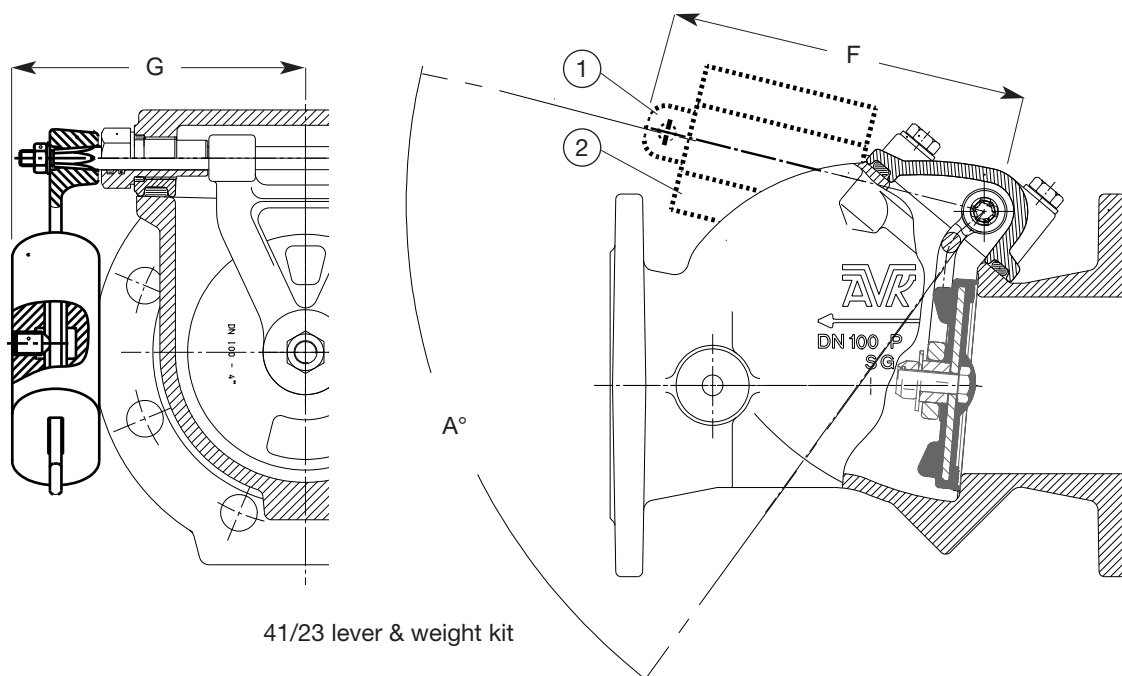

| DN  | Lever & weight kit<br>Ref.nos. | F<br>mm | G<br>mm | A°  | Weight kilos<br>(theoretical) | Spring kit<br>Ref.nos. | L<br>mm | Weight kilos<br>(theoretical) | Guard kit<br>Ref.nos. | A<br>mm | B<br>mm | C<br>mm | D<br>mm | E<br>mm | Weight kilos<br>(theoretical) |
|-----|--------------------------------|---------|---------|-----|-------------------------------|------------------------|---------|-------------------------------|-----------------------|---------|---------|---------|---------|---------|-------------------------------|
| 50  | 41-080-23000                   | 150     | 148     | 59° | 2.6 (2.5)                     | 41-050-32000           | 135     | 0.8                           | 41-080-50600          | 52      | 161     | 161     | 52      | 165     | 2.0                           |
| 65  |                                | 260     | 148     | 62° | 2.6 (2.5)                     | 41-065-32000           | 135     | 0.8                           |                       | 52      | 161     | 161     | 52      | 165     | 2.2                           |
| 80  |                                | 150     | 148     | 65° | 2.6 (2.5)                     | 41-080-32000           | 144     | 0.8                           |                       | 52      | 161     | 161     | 52      | 165     | 2.2                           |
| 100 | 41-100-23000                   | 185     | 158     | 67° | 5.2 (2.5)                     | 41-100-32000           | 141     | 0.9                           | 41-100-50600          | 52      | 161     | 161     | 52      | 175     | 3.0                           |
| 125 | 41-150-23000                   | 230     | 200     | 65° | 5.2 (5.0)                     | 41-125-32000           | 216     | 1.1                           | 41-150-50600          | 62      | 246     | 246     | 62      | 211     | 3.5                           |
| 150 |                                | 230     | 200     | 68° | 5.2 (5.0)                     | 41-150-32000           | 184     | 1.3                           |                       | 62      | 246     | 246     | 62      | 211     | 4.0                           |
| 200 | 41-200-23000                   | 280     | 230     | 71° | 12.5 (5.0)                    | 41-200-32000           | 217     | 1.5                           | 41-200-50600          | 62      | 291     | 291     | 62      | 241     | 4.5                           |
| 250 | 41-300-23000                   | 525     | 405     | 58° | 12.5 (8.5)                    | 41-300-32000           | 441     | 3.3                           | 41-300-50600          | 68      | 558     | 558     | 68      | 422     | 10.2                          |
| 300 |                                | 525     | 405     | 58° | 12.5 (8.5)                    |                        | 441     | 3.3                           |                       | 68      | 558     | 558     | 68      | 422     | 10.2                          |

All dimensions ± 2 mm